

# Electrical Fabrication 1 Learning System

950-ELF1

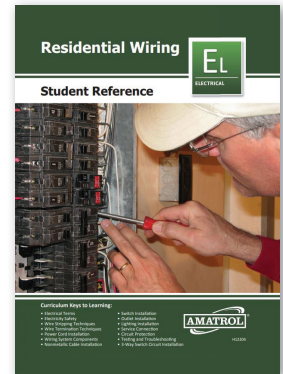

950-ELF1 Learning System



Student Reference Guide

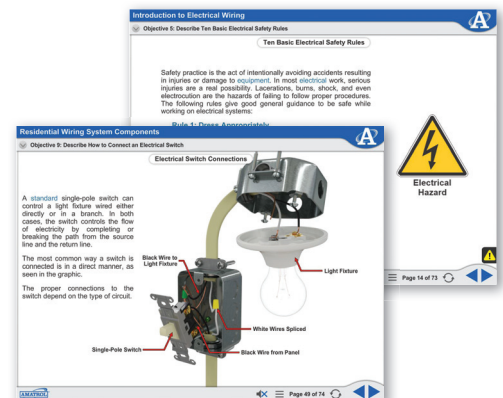

Screenshots of Interactive Multimedia Curriculum

## Learning Topics:

- Electrical Terms
- Electricity Safety
- Wire Stripping Techniques
- Wire Termination Techniques
- Power Cord Installation
- Wiring System Components
- Nonmetallic Cable Installation
- Switch Installation
- Outlet Installation
- Lighting Installation
- Service Connection
- Circuit Protection
- Testing and Troubleshooting
- 3-Way Switch Circuit Installation

Amatrol's Electrical Fabrication 1 Learning System (950-ELF1) teaches students skills that are commonly used by electricians, technicians, and engineers in today's industry. Installing, operating, repairing, or designing equipment for modern industry requires fundamental knowledge of electrical wiring and components. Students will gain expertise in key skill areas such as basic electrical system wiring, interpreting wire installation plans, handling non-metallic cable, installing basic components such as switches, outlets, and lighting, and connecting electrical services.

The model 950-ELF1 includes a workstation, wiring components, storage case, hand tool package, electrical consumable package, electrical accessories, multimedia student curriculum, instructor's assessment guide, and installation guide.



## Technical Data

Complete technical specifications available upon request.

Electrical Fabrication Unit (T7021)  
Hand Tool Package (33565)  
Electrical Package (33567)  
Electrical Consumable Package (33566)  
Student Curriculum (M12204)  
Instructor's Guide (C12204)  
Installation Guide (D12204)  
Student Reference Guide (H12204)

### Additional Requirements:

82-610 Mobile Technology Workstation or equivalent  
For PC requirements, see <http://www.amatrol.com/support/computer-requirements>

### Utility Requirements:

120V/60Hz/1ph electrical

## Hands-On, Job-Ready Industry Skills

The 950-ELF1 covers industry-relevant essential electrical fabrication skills. These skill areas include test checking with a voltage tester, checking electrical components for UL and CSA standards approval, stripping insulation from wires, installing spade-lug connectors, connecting wires to a terminal strip, reading and interpreting a wiring installation plan, and safely and properly installing electrical wiring, lighting, and components.



## Safety Emphasized at All Levels

The 950-ELF1 not only teaches students proper installation of electrical wiring and components but also the importance of safe installation. Student curriculum emphasizes basic safety rules as well as the National Electrical Code (NEC) and other safety approval ratings. Students develop skills to identify and work with components that are marked with these safety ratings. Students also learn about and apply circuit protection and how to properly operate, install, and test circuit breakers.

## Interactive Electrical Fabrication Multimedia Curriculum

Amatrol's unmatched multimedia utilizes text, audio, and stunning 3D animations that engage learners in both theoretical knowledge and hands-on skills. This thorough, exceptionally detailed curriculum is built to begin with the basics and steadily advance to more complex concepts and skills. Through partnerships with key industry leaders and leading edge educators, Amatrol developed the right balance of knowledge and applied skills needed to train learners to work in their chosen field.

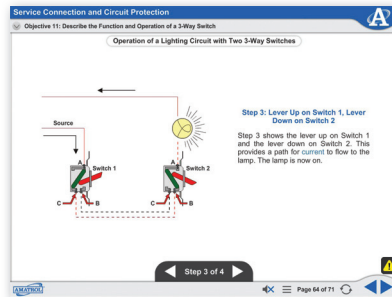

Screenshot of Interactive Multimedia Curriculum

## Student Reference Guide

A sample copy of this course's Student Reference Guide is included with the learning system. Sourced from the multimedia curriculum, the Student Reference Guide takes the entire series' technical content contained in the learning objectives and combines them into one perfect-bound book. Student Reference Guides supplement this course by providing a condensed, inexpensive reference tool that learners will find invaluable once they finish their training, making it the perfect course takeaway.

